

CDi-XR AND CDt-XR CD PLAYERS

When to update?

Cyrus CDi-XR and CDt-XR CD players feature user-upgradable firmware via ports on the back panel.

Owners can check the Cyrus website for notification of updates or register their products to receive notification when updates are released.

Dual firmware ports

The CDi-XR and CDt-XR include dual firmware update ports, one for the 'UI' (user interface controller) and one for the 'SERVO' (servo controller). Both ports should always be updated with the latest versions available from Cyrus.

To avoid any errors in update, complete the update for UI, then repeat the process, starting from download for Servo.

The version numbers for the UI and SERVO updates must always be the same.

COMPUTERS AND OPERATING SYSTEMS

Cyrus firmware upgrades are possible using an Apple Mac computer. No special app is required, just basic file management skills to download, copy and delete files.

IMPORTANT NOTE: The following procedure copies the firmware file using a terminal window. This must be followed for successful firmware updates. Do not use any other copy and paste method as this may risk the placement of additional system files in the memory of the CD player and prevent firmware installation.

TOOLS REQUIRED

The CD player will not require dismantling.

A mini USB cable (supplied) and the upgrade firmware will also be required.

NOTE: Not all mini USB cables are data cables, some are charging cables. A charging cable is not suitable for firmware upgrades. Always use the cable supplied with the CD player where possible.

DOWNLOAD

Download the firmware you require from the Cyrus website at www.cyrusaudio.com.

The firmware file name will be contained in a zip file in the format 'CW12_MCU_2v0_10.zip' where the red numbers in the example will change to indicate the firmware version. This 1v4_8 firmware version will be used through the rest of this example instruction sequence.

File name formats may change from time to time, but CD player firmware will always be prefixed 'CW12' and will clearly include the version number.

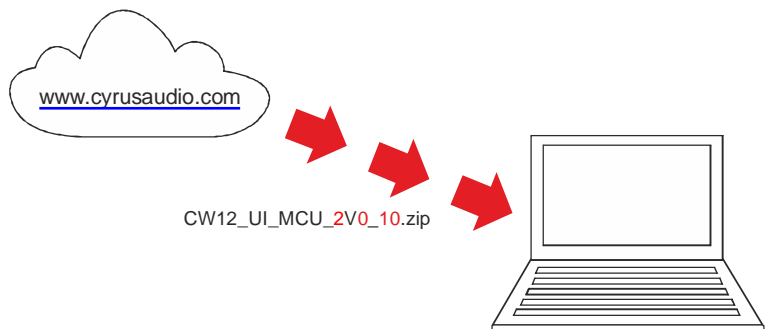

LOCATION OF FIRMWARE

The firmware update files are packaged with these instructions in separate folders in the 'zip' file download.

Do NOT attempt to transfer the downloaded file to the product. To unzip the file double click on the downloaded file, which will extract the files to the folder that the zip file was downloaded to.

Zip file

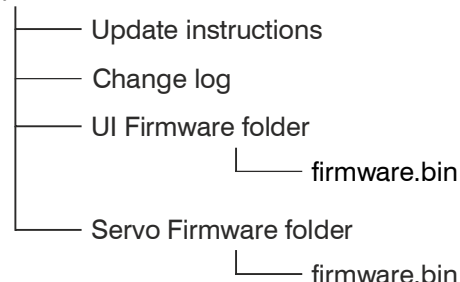

DISCONNECT

Disconnect mains power from the CD player.

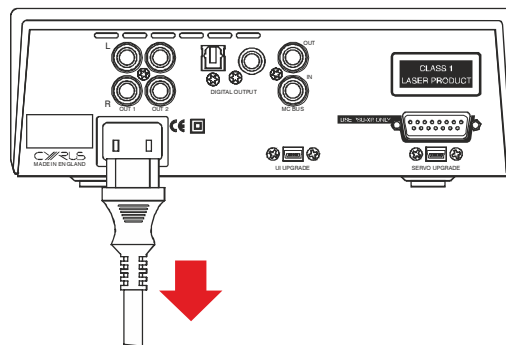

CONNECT UI

Connect the update cable to the computer.

Connect the update cable to the UI UPGRADE port on the back of the CD player.

Connect mains power to the CD player.

Connect mains power to the CD player.

Don't operate the CD player controls in any way during UI update and ignore any display indications.

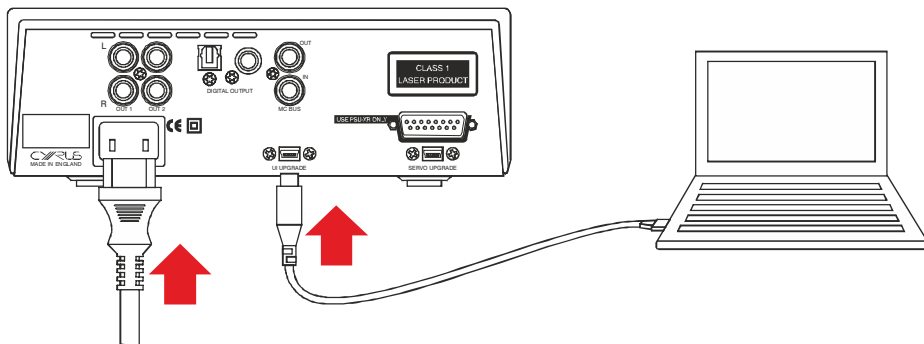

UPGRADE UI

Follow the instructions on the next page to upgrade the UI firmware.

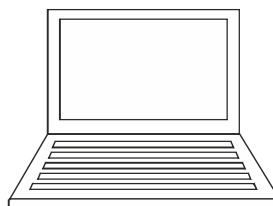

LOCATE CURRENT UI FIRMWARE

Press $\text{⌘} + \text{Shift} + \text{C}$ to display locations on the computer.

From the Finder window you opened.
Select the CRP DISABLD folder.

The file displayed is the current firmware.

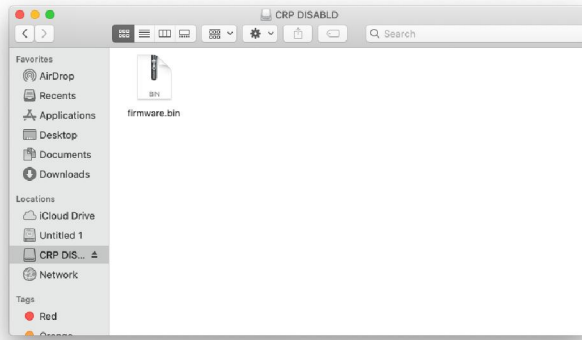

LAUNCH TERMINAL

Press $\text{⌘} + \text{Space}$ to open a search window.

Search for 'Terminal'.

Select this option.

A terminal window will open.

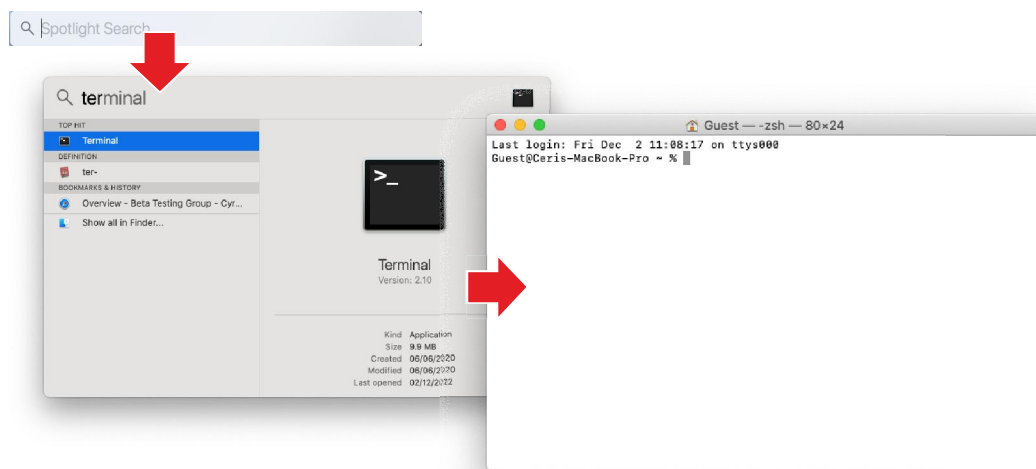

DELETE ORIGINAL

Delete the original firmware file from the amplifier.

Type 'rm'

Type a space.

Drag the firmware.bin file from this drive in the finder window into the terminal window.

Press ' ↵ '

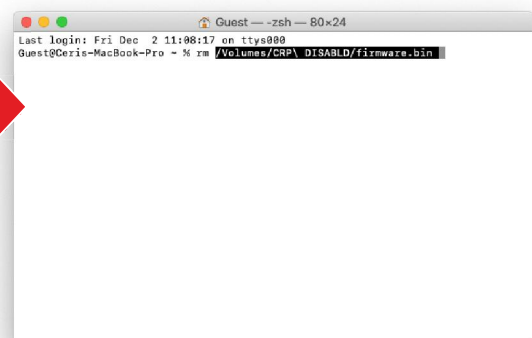
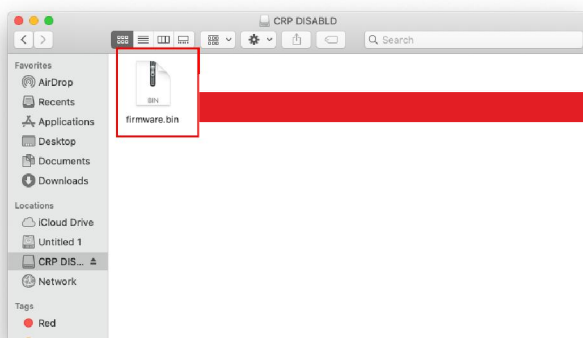
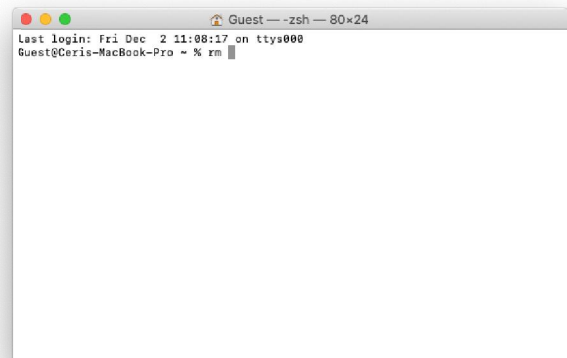

UPDATE UI

In the Terminal window, type 'cp'.
Type a space.

NOTE: Don't press ENTER!

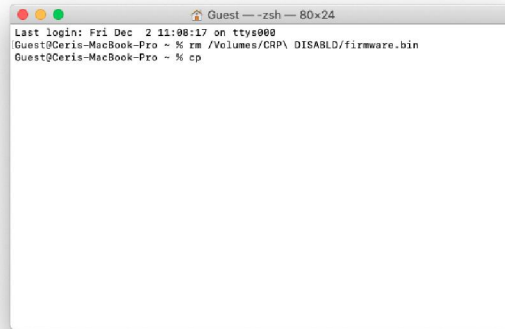

From the Finder window.
Select the Downloads folder.
Navigate into the 'UI Firmware' folder
within the download package.
Drag firmware.bin from the Finder
window into the Terminal window.

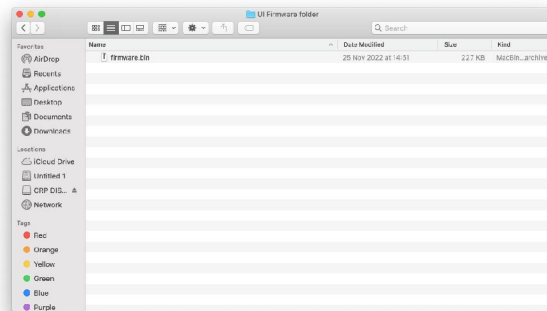

Check there's a space at the end of
the line. If not, type one.

NOTE: Don't press ENTER!

Press ⌘+Shift+C to display locations
on the computer.

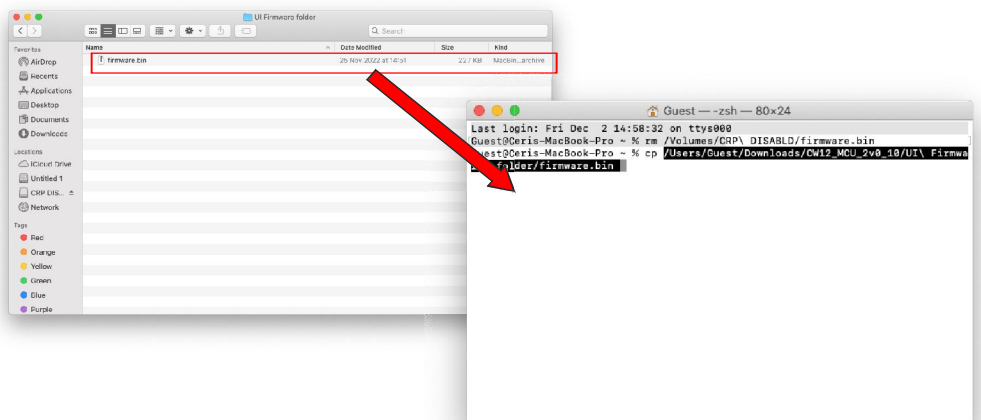

From this screen, drag the CRP
DISABLD volume into terminal.
From the terminal window, press ←.
The firmware will be updated.

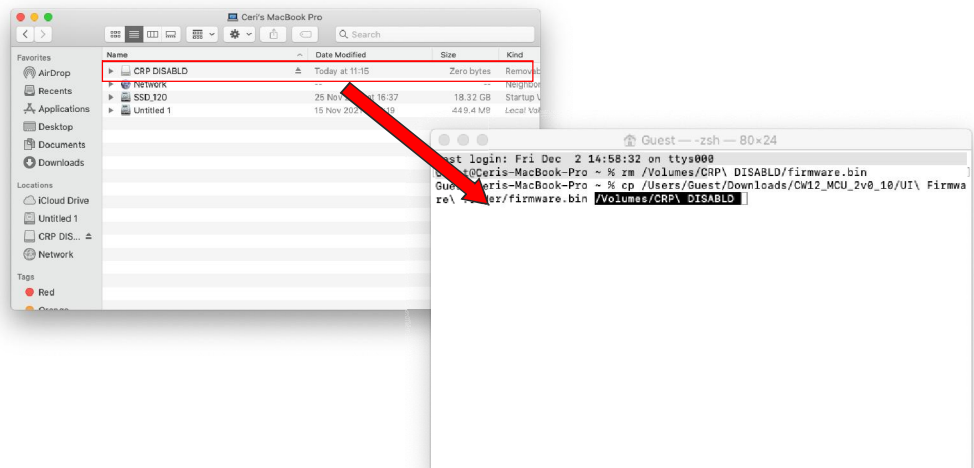

DISCONNECT UI

Disconnect the update cable from the UI UPGRADE port.

Disconnect mains power.

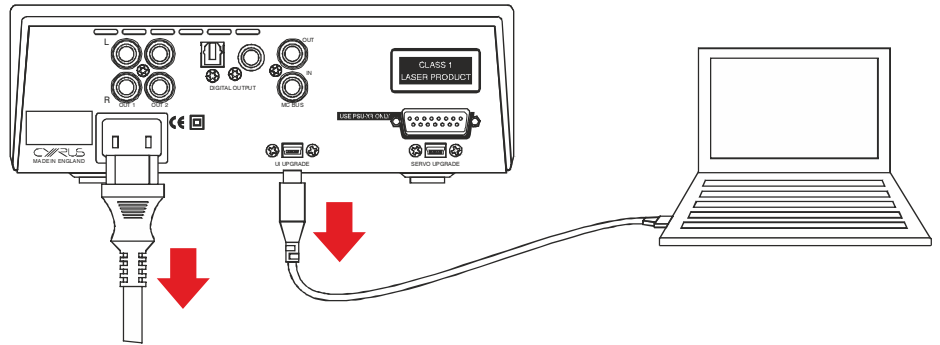

CONNECT SERVO

Connect the update cable to the SERVO UPGRADE port on the back of the CD player.

Connect mains power to the CD player.
Don't operate the CD player controls in any way during servo update and ignore any display indications.

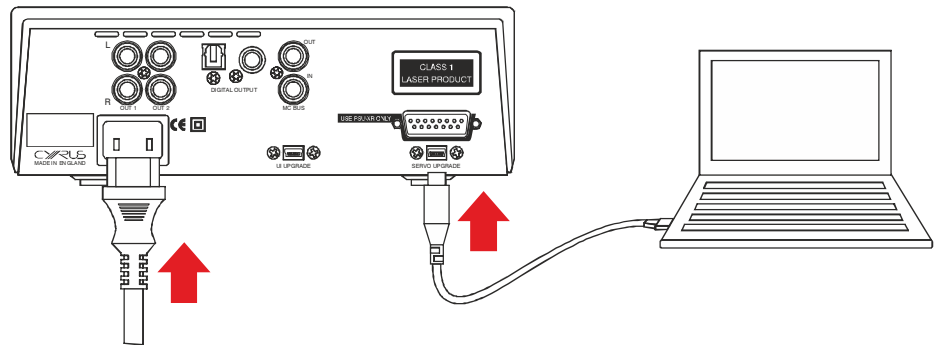

ERROR DISPLAY

When power is connected the display will read 'Error Unknown System Model'. This is normal at this point in the upgrade process.

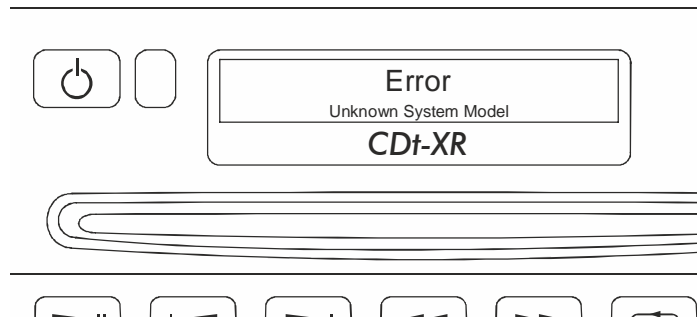

UPDATE SERVO

Follow the instructions on the next page to update the SERVO firmware.

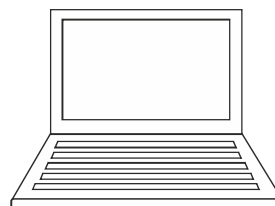

LOCATE CURRENT SERVO FIRMWARE

From the Finder window, select the CRP DISABLD folder.

The file displayed is the current firmware.

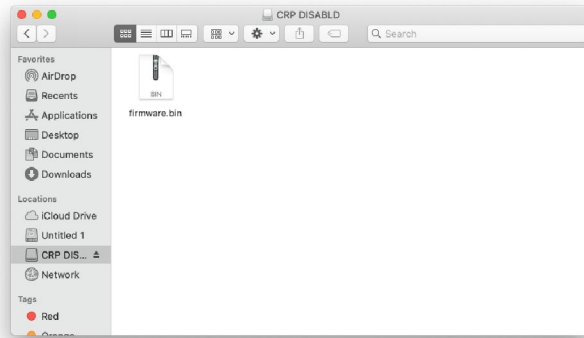

DELETE ORIGINAL

Delete the original servo firmware file from the CD player

Type 'rm'

Type a space.

Drag the firmware.bin file from this drive in the finder window into the terminal window.

Press '↵'

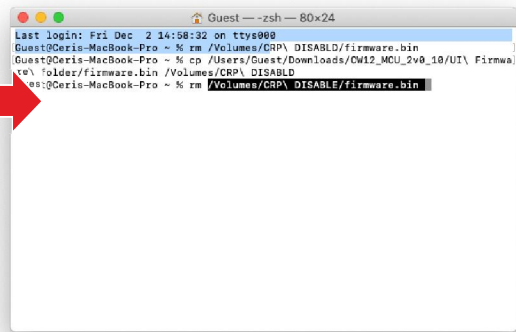
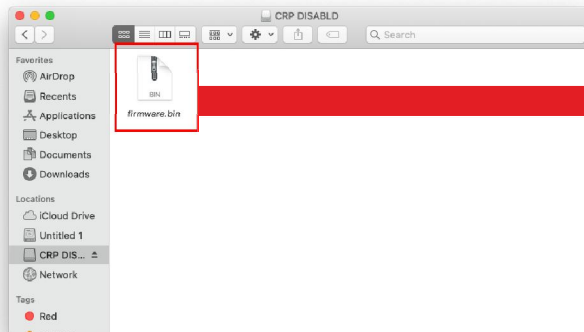
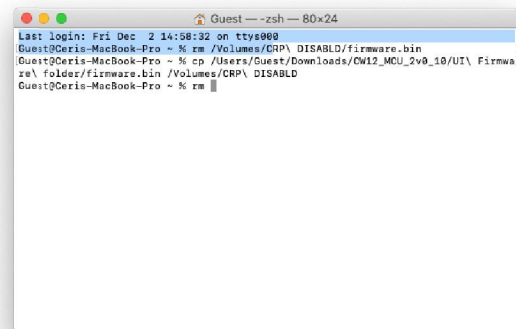

UPDATE SERVO

In the Terminal window, type 'cp'.
Type a space.

NOTE: Don't press ENTER!

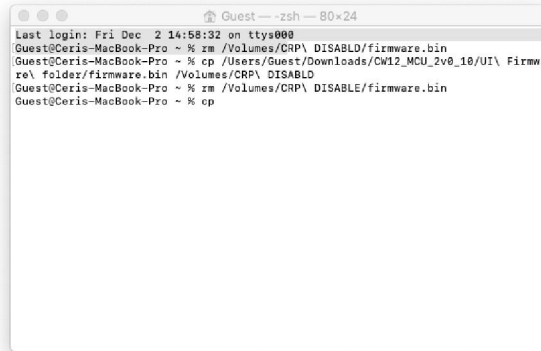

```
Guest -- zsh -- 80x24
Last login: Fri Dec 2 14:58:32 on ttys000
Guest@Ceriis-MacBook-Pro ~ % rm /Volumes/CRP\ DISABLE/firmware.bin
Guest@Ceriis-MacBook-Pro ~ % cp /Users/Guest/Downloads/CW12_MCU_2v0_10/UI\ Firmwa
re\ folder/firmware.bin /Volumes/CRP\ DISABLE
Guest@Ceriis-MacBook-Pro ~ % rm /Volumes/CRP\ DISABLE/firmware.bin
Guest@Ceriis-MacBook-Pro ~ % cp
```

From the Finder window.
Select the Downloads folder.
Navigate into the 'Servo Firmware'
folder within the download package.
Drag firmware.bin from the Finder
window into the Terminal window.

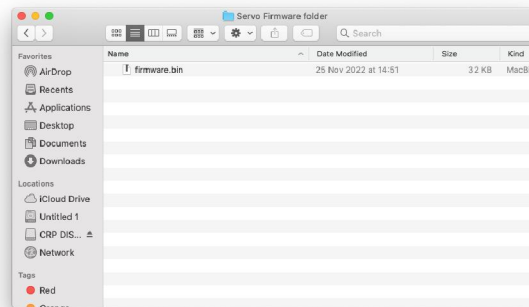

Check there's a space at the end of
the line. If not, type one.

NOTE: Don't press ENTER!

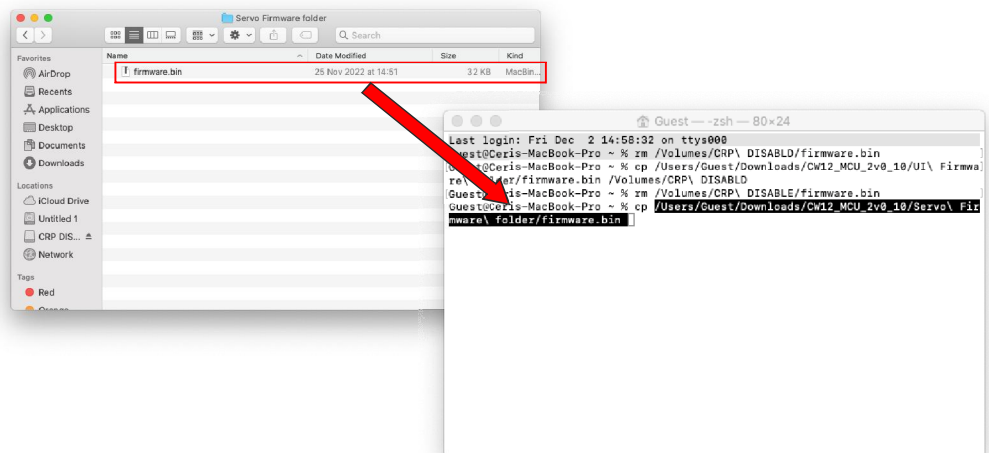

Press **⌘+Shift+C** to display locations
on the computer.

From this screen, drag the CRP
DISABLD volume into terminal.

From the terminal window, press **←**.
The firmware will be updated.

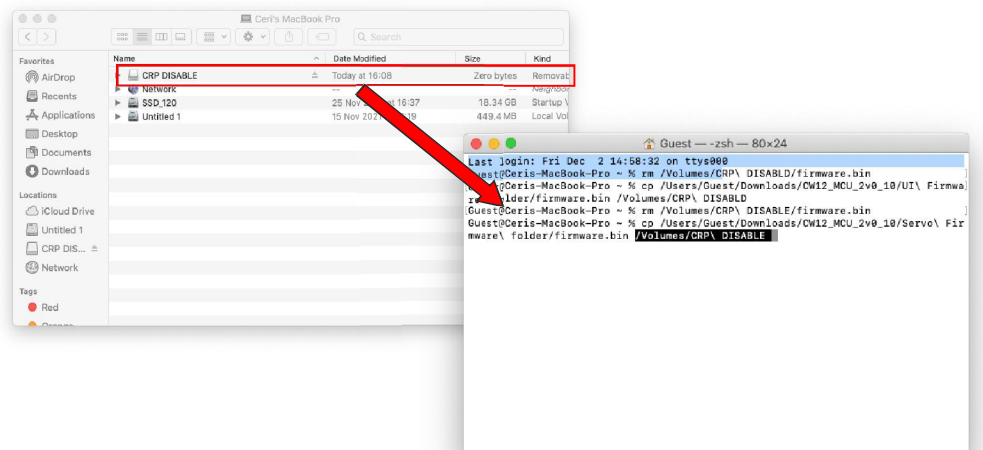

DISCONNECT

Disconnect the SERVO update cable.
Disconnect mains power.

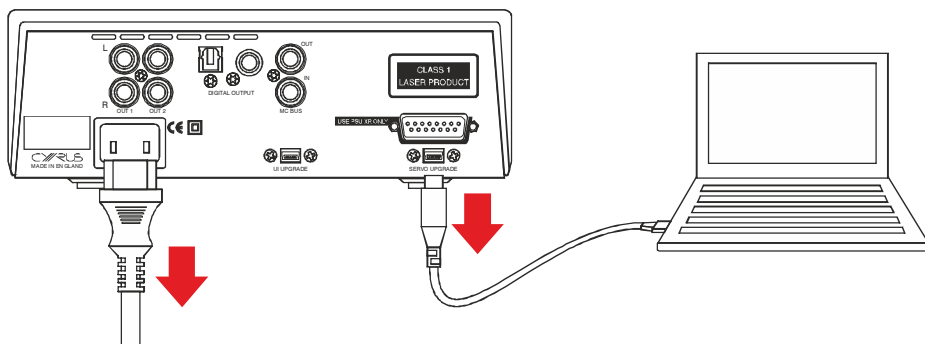

CONNECT POWER

Re-connect mains power.

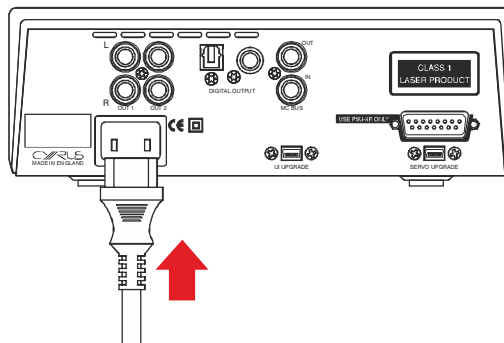

CHECK VERSION

Power up the player.

Press 'i' on the remote control.

Confirm that the updated firmware version is listed on the display.

NOTE: If the UI and SERVO firmware version numbers are mismatched, the message 'Incompatible Firmware' will be displayed when power is connected. In this case, repeat the update process from the beginning including file download.

