

XR AMPLIFIERS

When to update?

Cyrus i7-XR, i9-XR and Pre-XR amplifiers feature user-upgradable firmware via ports on the back panel.

Owners can check the Cyrus website for notification of updates or register their products to receive notification when updates are released.

Compatibility

The same firmware download is used for the i7-XR, i9-XR and Pre-XR models. The firmware can auto-detect the amplifier type and enable model specific features as required.

COMPUTERS AND OPERATING SYSTEMS

Cyrus firmware upgrades are possible using an Apple Mac computer. No special app is required, just basic file management skills to download, copy and delete files.

IMPORTANT NOTE: The following procedure copies the firmware file using a terminal window. This must be followed for successful firmware updates. Do not use any other copy and paste method as this may risk the placement of additional system files in the memory of the amplifier and prevent firmware installation.

TOOLS REQUIRED

The amplifier will not require dismantling.

A mini USB cable (supplied) and the upgrade firmware will also be required.

NOTE: Not all mini USB cables are data cables, some are charging cables. A charging cable is not suitable for firmware upgrades. Always use the cable supplied with the amplifier where possible.

DOWNLOAD

Download the firmware you require from the Cyrus website at www.cyrusaudio.com.

The firmware file name should be contained in a zip file in the format 'CW09_MCU_2v0_12.zip' where the red numbers in the example will change to indicate the firmware version.

The downloaded file will be located in the Downloads folder.

NOTE: The Downloads folder is the default location for downloads unless an alternative download folder was specified when the computer was set up.

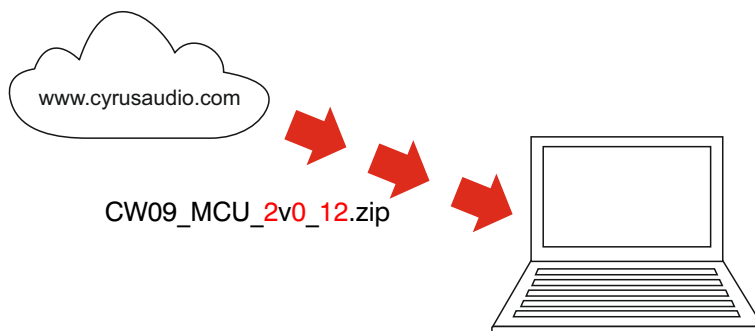

DISCONNECT

Disconnect the power cable.

Signal cables etc can remain connected.

If the back panel is not easily accessible, a mini USB cable may be permanently connected to the upgrade port.

NOTE: With this arrangement, ensure that the free end of that cable is only connected to a computer during update.

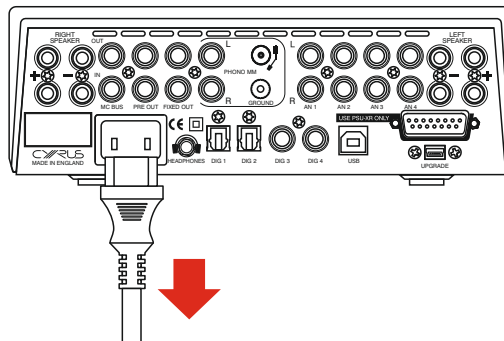

CONNECT

The amplifier is connected to the computer with a mini-USB cable (supplied). If you don't have a USB A port on your MAC you will require a mini-USB cable or adapter that matches the connections on your computer.

1. Connect the update cable to the computer.
2. Press and hold the front panel rotary control.
3. While holding the rotary control, connect the mini-USB cable to the UPGRADE port on the back of the amplifier.
4. Release the rotary control.

It is not necessary to connect mains power.

The amplifier is now ready to update.

Don't operate the amplifier controls in any way during update.

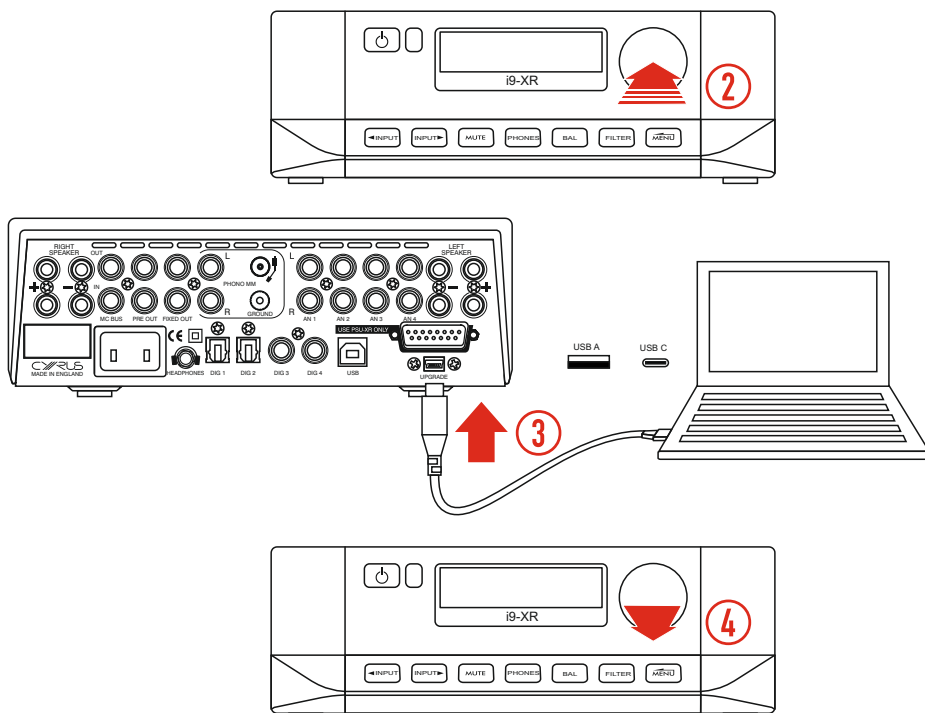

UPDATE

Follow the instructions on the next page to update the firmware.

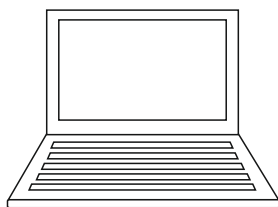

LOCATION OF FIRMWARE

- The firmware update file is packaged with these instructions in the 'zip' file download.

Zip file

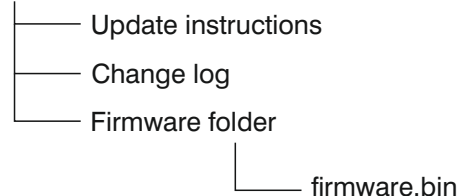

LOCATE CURRENT FIRMWARE

- Press $\text{⌘} + \text{Shift} + \text{C}$ to display locations on the computer.
- From the Finder window you opened
- Select the CRP DISABLD folder.
The file displayed is the current firmware.



LAUNCH TERMINAL

- Press $\text{⌘} + \text{Space}$ to open a search window.
 - Search for 'Terminal'.
 - Select this option.
- A terminal window will open.*

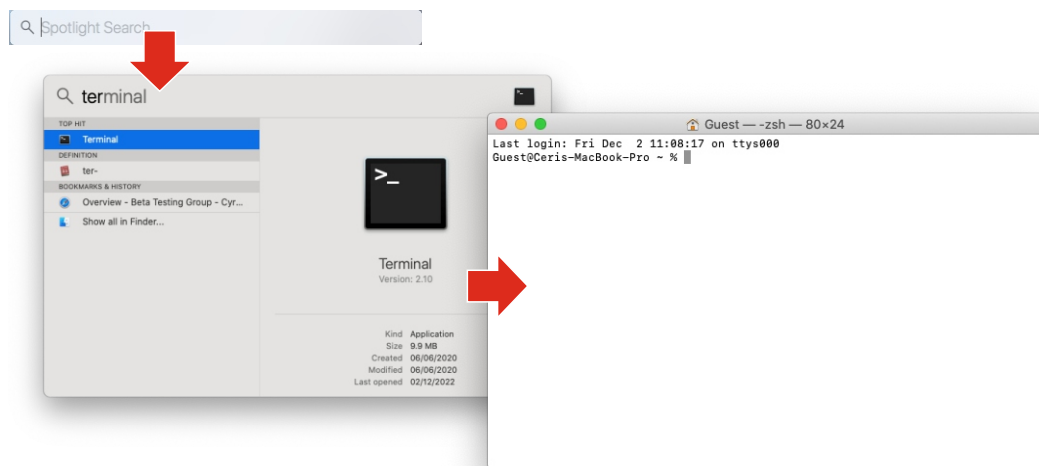

DELETE ORIGINAL

Delete the original firmware file from the amplifier.

- Type 'rm'
- Type a space.
- Drag the firmware.bin file from this drive in the finder window into the terminal window.
- Press ' $\text{⌘} + \text{V}$ '

①

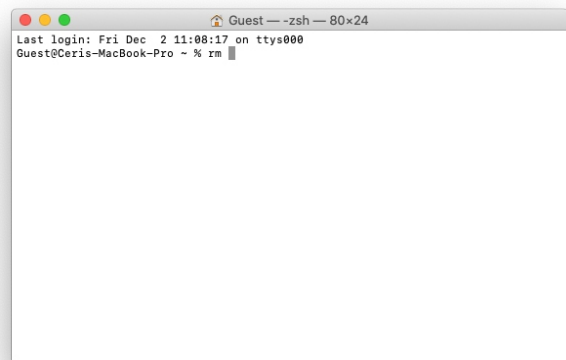

②

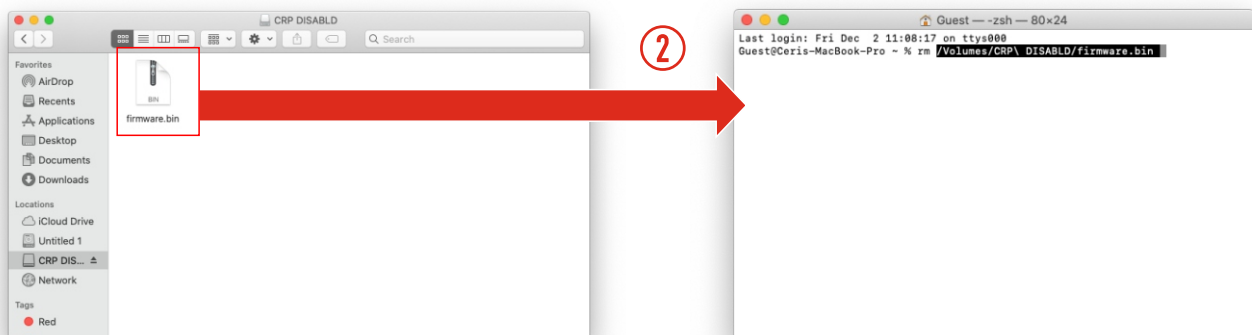

UPDATE

- In the Terminal window, type 'cp'.
- Type a space.

NOTE: Don't press ENTER!

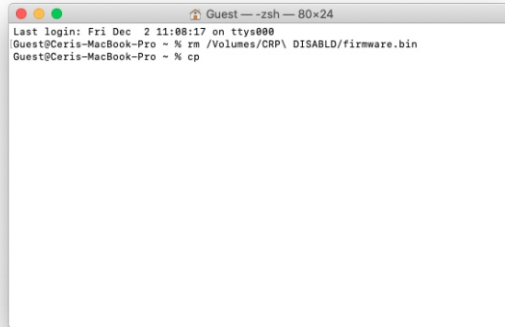

- From the Finder window.
- Select the Downloads folder.
- Navigate into the 'Firmware' folder within the download package.

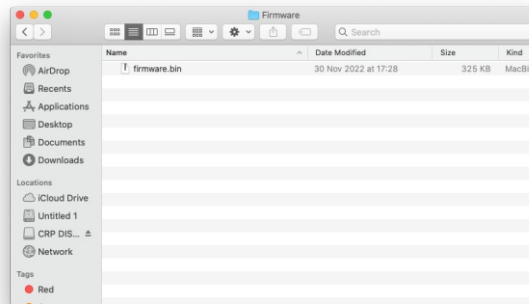

Drag firmware.bin from the Finder window into the Terminal window.

- Check there's a space at the end of the line. If not, type one.

NOTE: Don't press ENTER!

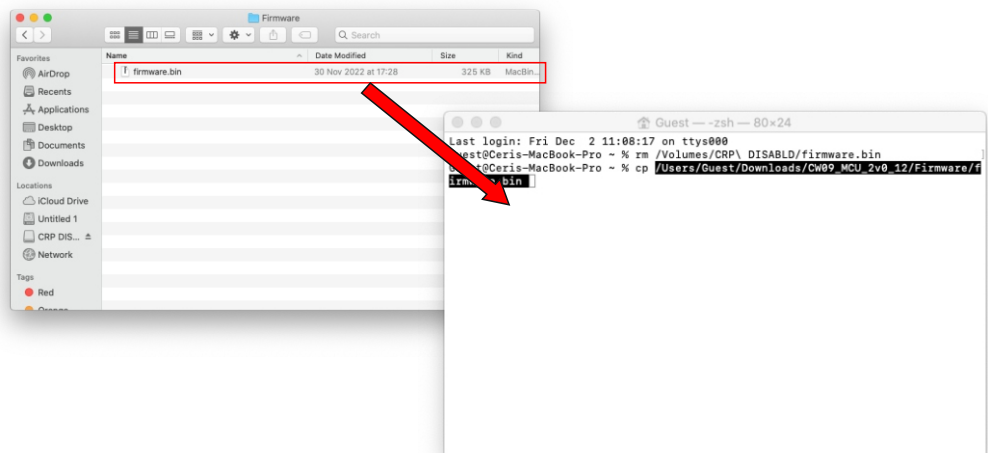

- Press $\text{⌘} + \text{Shift} + \text{C}$ to display locations on the computer.
- From this screen, drag the CRP DISABLD volume into terminal.
- From the terminal window, press ⏏ .
- The firmware will be updated.

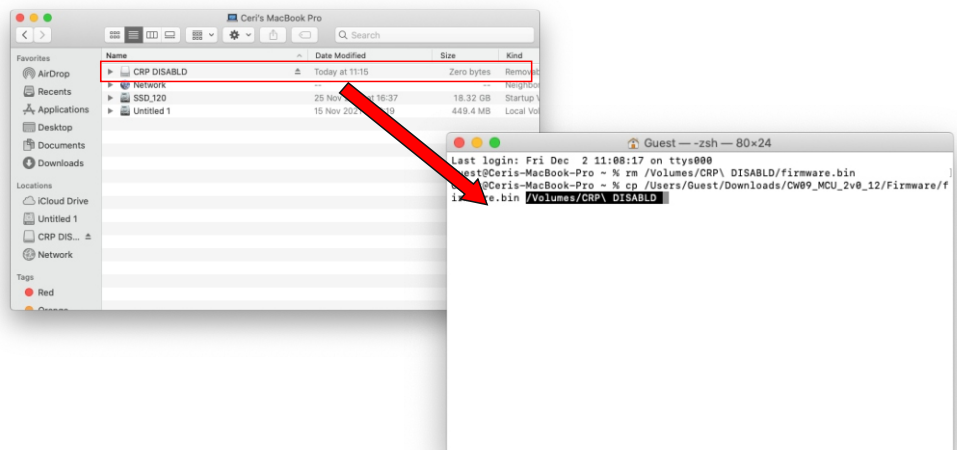

DISCONNECT

- Disconnect the update cable.

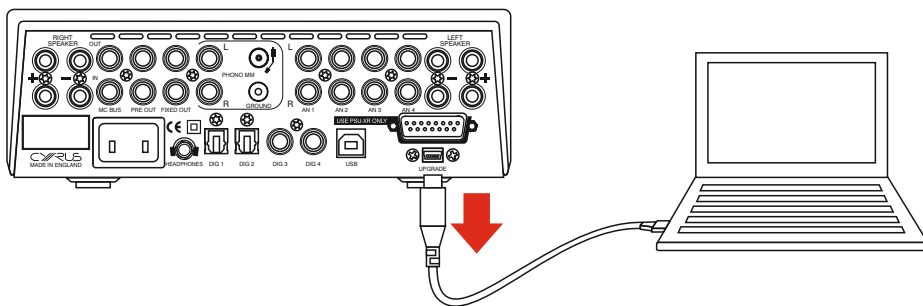

CONNECT POWER

Re-connect mains power.

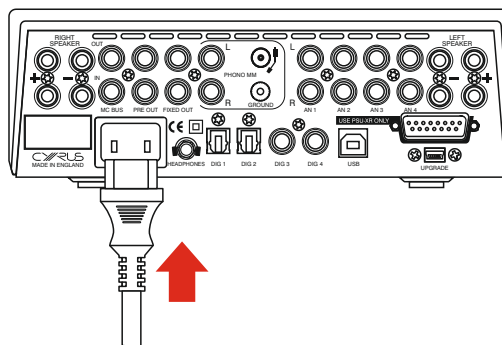

CHECK VERSION

- Power up the amplifier.
- Press 'i' on the remote control.

Confirm that the updated firmware version is listed on the display.

